

SPHERICAL HEAD ANCHOR LIFTING DEVICES

The spherical head lifting anchor system has long been in use for hoisting, transporting and assembling concrete elements.

The anchor is secured in the concrete by means of a rubber former. Once the concrete has cured, the former can be removed from the element mould. The design of the clutch ensures safe and tight connection to the anchor.

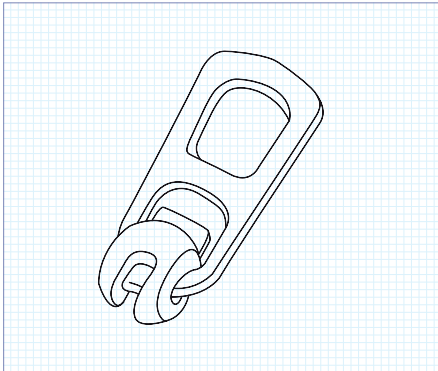

LIFTING CLUTCHES - TYPE H2

Zinc-plated, with test certificate. The universal lifting clutch is made of wear resistant and age-resistant steel. This clutch can also be used for tilting.

The spherical ball fits exactly in the concrete cavity. Thanks to the weight distribution, it is impossible for the ball on the lifting clutch to come loose from the anchor when under load. This means that no separate locking mechanism is necessary.

The lifting clutch is delivered with an individual certificate in accordance with European standards.

After the lifting clutch has been tested with a test load of three times the authorised load, it is given an individual number which corresponds to the number on the test certificate.

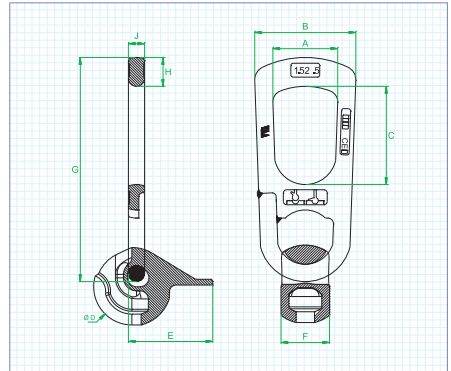

Part No	Load Group, T	A	B	C	D	E	F	G
		mm						
CFS-H2-013	1.3	44	74	70	56	54	32	162
CFS-H2-025	2.5	56	88	85	68	66	42	196
CFS-H2-050	5	68	118	88	88	83	57	237
CFS-H2-075/100	10	82	160	112	112	113	73	339
CFS-H2-150/200	20	113	191	135	152	151	110	447
CFS-H2-320	32	175	269	189	195	214	153	584

45t available on request

In addition to chain sets you may require one of the following lifting devices. Please check with your flooring company which type of lifting anchor has been cast in.

Spherical Head Clutch

1.3T to 32T SWL



Threaded Lifting Loop

0.5T to 12.5T SWL



Quick Lift Clutch

1.3T to 26T SWL



Rotating Eye Lifter

0.5T to 12.5T SWL

