

			Drawn by:	TAW
			Date:	19/05/08
			Checked by:	
			Date:	
Rev.		Dwn	Date	Scale: NTS
Title: Typical section through retaining wall c/w insitu boot			Drawing No:	SK003
			Revison:	-

Design assumptions

Precast retaining walls designed to resist a retained materials and a floor slab surcharge load of 10kN/m².

Retaining walls have been designed for a ground bearing pressure of 100kN/m².

Other loading and bearing pressure criteria can be catered for within our standard design.

Preparatory work is to be carried out by yourselves in the provision of stone and adequate concrete blinding to formation level. The blinding/stone must be sufficient to support the weight of the wall stem in the temporary state until the insitu boot has been cast.

It is the main contractors responsibility to ensure that the blinding and substrata are capable of withstanding the overturning forces that may be exerted by the precast walls.

Walls are not designed for vehicular impact and should therefore be protected by Armco barrier or similar.

The retained area to the rear of the wall will be free draining and a suitable land drain provided to avoid the possibility of build up of hydrostatic pressure. we not included for weep holes.

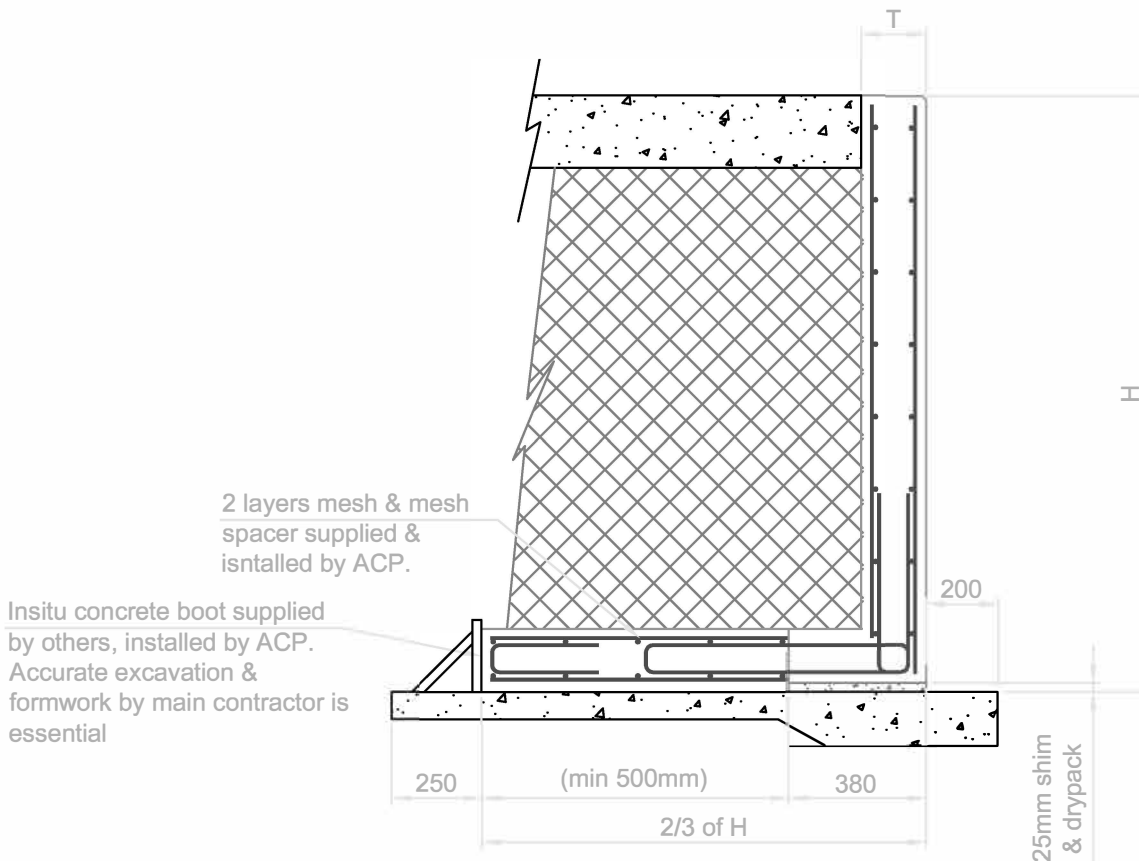

min. recommended blinding extent

TYPICAL SECTION